

Unique Development Opportunity

Spectacular Lake View Property At Peachland

Columbia Landing



For Sale

3.1 Acres of prime view property located in the heart of the Okanagan.

Zoned R3 - Low Density Residential - Allows up to 15 units per acre.

The official Community Plan designates this property as R4 – Medium Density Residential allowing up to 24 units per acre.

**Al McLeod
Greenwood Realty Group
604 644 0293
amcleod@shaw.ca**

Amenities

- **Spectacular lake and mountain views**
- **Walking distance to downtown Peachland and lakeshore**
- **Municipal service available on the site or nearby**



Peachland is a friendly community located on the shore of Lake Okanagan and is just 30 kms (20 miles) south of Kelowna; the largest city in the valley. Kelowna offers arts, theatre, entertainment, hospitals, hotels, restaurants, a casino and shopping.

Temperatures average 24 degrees celsius in the summer and just above freezing in the winter. Sunshine radiates for over 2, 000 hours per year.

Lush fruit orchards and beautiful vineyards are abundant, creating a vibrant wine industry. Residents and visitors enjoy tasting the award winning wines produced. The area boasts swimming, boating, fishing and canoeing. There are many hiking, biking and nature trails. World class skiing and golfing: Big White, Silver Star, and Apex Ski Resorts are within an hours drive away. The area offers over forty golf courses.

The Okanagan Valley is truly a recreational paradise!

Peachland and Kelowna

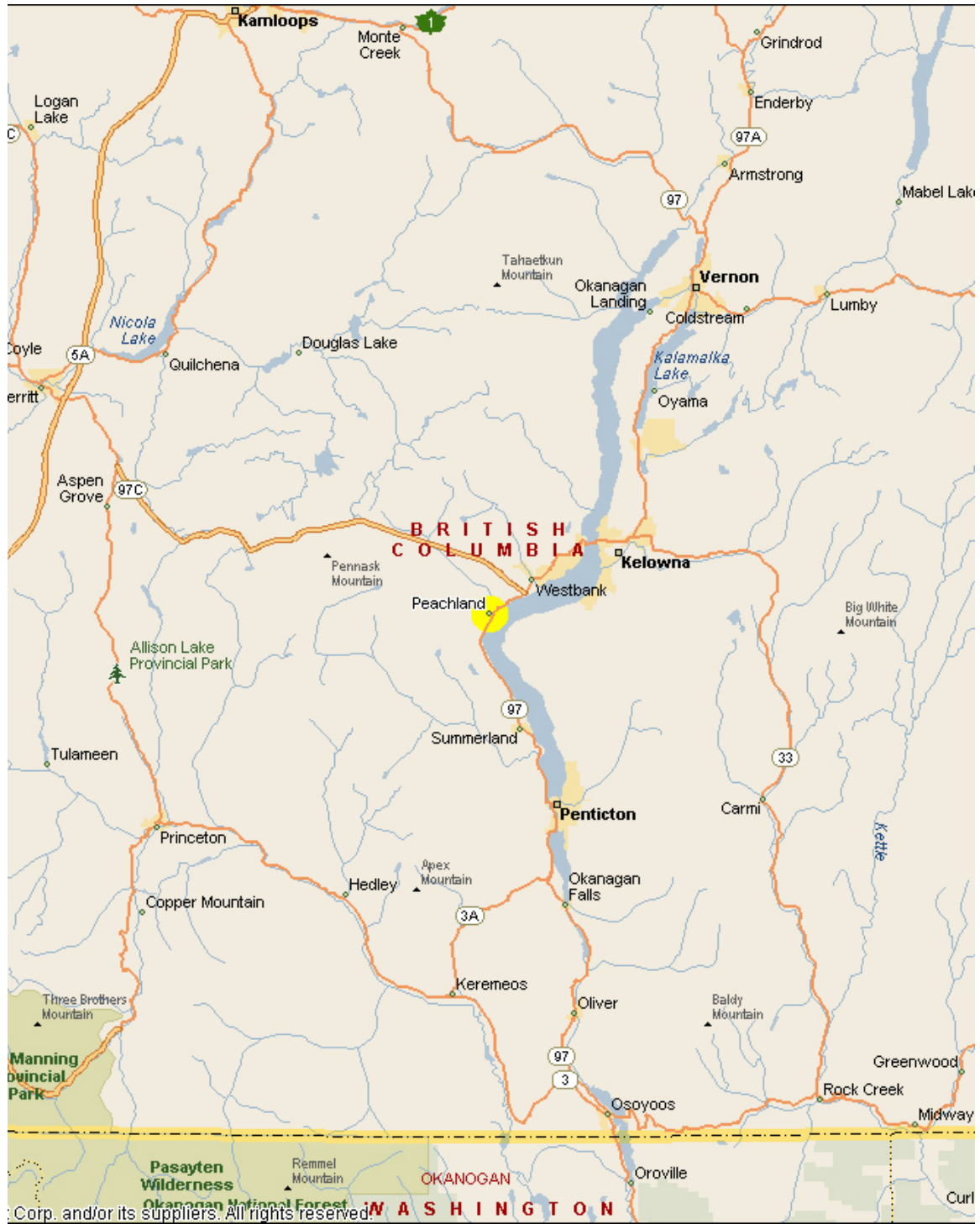

3.1 Acres – Columbia Landing

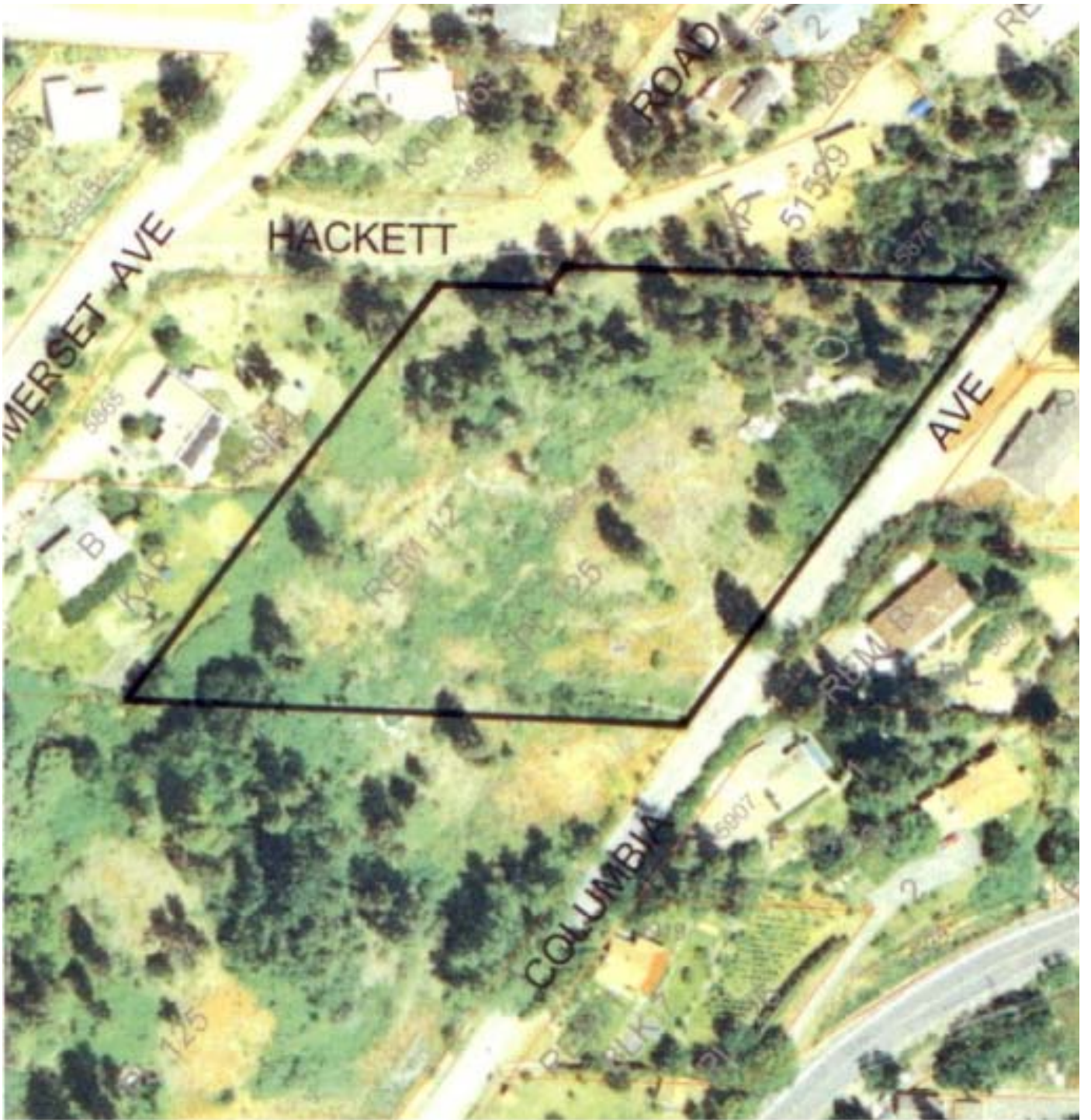

Peachland Reference Material

Nearest Cities: [Kelowna](#)
[Summerland](#)

Wineries: [Hainle Vineyard Estate Winery](#)
[Cedar Creek Estate Winery](#)
[Gray Monk Estate Winery](#)
[Hawthorne Mountain Vineyards – OK Falls](#)
[Mission Hill Winery](#)
[Mount Boucherie Estate Winery](#)
[Summerhill Estate Winery](#)

Golfing: [Harvest Golf Club](#)
[Ponderosa Golf and Country Club](#)
[Shannon Lake Golf Course](#)



Al McLeod
Greenwood Realty Group
604 644 0293
amcleod@shaw.ca